

**BASIC DETAILS****20514--ST SOLDIER ELITE CONV SCH, JANDIALA GURU PUNJAB****Dated : 28/09/2020**

<b>SCHOOL NAME</b>	ST SOLDIER ELITE CONV SCH, JANDIALA GURU PUNJAB	<b>SCHOOL CODE</b>	20514
<b>ADDRESS</b>	ST SOLDIER ELITE CONVENT SCHOOL, JYOTISAR COLONY, JANDIALA GURU, DISTT AMRITSAR	<b>AFFILIATION CODE</b>	1630525
<b>PRINCIPAL</b>	MRS AMARPREET KAUR	<b>PRINCIPAL'S CONTACT NUMBER</b>	9855078318
<b>PRINCIPAL'S EMAIL ID</b>	ebadit.cute@gmail.com	<b>PRINCIPAL'S RETIREMENT DATE</b>	31/03/2033
<b>SCHOOL'S CONTACT NUMBER</b>	91-9872111347	<b>SCHOOL'S EMAIL ID</b>	stsoldierschool@yahoo.com
<b>SCHOOL'S WEBSITE</b>	www.ssecschool.com	<b>SCHOOL'S FAX NUMBER</b>	000000000
<b>LANDMARK NEAR SCHOOL</b>	Gurdwara Jyotisar Colony	<b>YEAR OF ESTABLISHMENT</b>	2004
<b>AFFILIATION VALIDITY</b>	2008 TO 2019	<b>AFFILIATION STATUS</b>	REGULAR
<b>NAME OF THE TRUST/SOCIETY/COMPANY REGISTERED WITH</b>	ST SOLDIER DAY BOARDING SCHOOL SOCIETY	<b>REGISTRATION DATE</b>	27/08/1999
<b>SOCIETY REGISTRATION NUMBER</b>	ASR/19 OF 1999-2000	<b>REGISTRATION VALIDITY</b>	PERMANENT REGISTRATION
<b>NOC ISSUING AUTHORITY</b>	PUNJAB GOVERNMENT	<b>NOC ISSUING DATE</b>	24/06/2008

<b>NO OBJECTION CERTIFICATE</b>	<b>VIEW (PdfHandler.aspx? FileName=G:\cbse\2018\oasis\noc\20514.PDF)</b>	<b>NON PROPRIETARY CHARACTER AFFIDAVIT/NON PROFIT COMPANY AFFIDAVIT</b>	<b>VIEW (PdfHandler.aspx? FileName=G:\cbse\2018\oasis\affidavit\20514.PDF)</b>
-------------------------------------	--	---	--

20514--ST SOLDIER ELITE CONV SCH, JANDIALA GURU PUNJAB  
Dated : 06/10/2020

## FACULTY DETAILS

<b>TOTAL NUMBER OF TEACHERS (ALL CLASSES)</b>	85	<b>NUMBER OF PGTs</b>	23
<b>NUMBER OF TGTs</b>	26	<b>NUMBER OF PRTs</b>	27
<b>NUMBER OF PETs</b>	4	<b>OTHER NON-TEACHING STAFF</b>	9
<b>NUMBER OF MANDATORY TRAINING QUALIFIED TEACHERS</b>	85	<b>NUMBER OF TRAININGS ATTENDED BY FACULTY SINCE LAST YEAR</b>	5
<b>WHETHER SPECIAL EDUCATOR APPOINTED?</b>	YES	<b>WHETHER COUNSELLOR AND WELLNESS TEACHER APPOINTED?</b>	YES
<b>HAS MANDATORY TRAINING OF TEACHERS AS PER THE TRAINING POLICY (SECTION-16 OF AFFILIATION BYE-LAWS) (<a href="http://cbseaff.nic.in/cbse_aff/attachment/onlineservices/affiliation-Bye-Laws.pdf">http://cbseaff.nic.in/cbse_aff/attachment/onlineservices/affiliation-Bye-Laws.pdf</a>) BEEN COMPLETED?</b>	YES	<b>NUMBER OF NTTs</b>	5

**STUDENT DETAILS**

20514--ST SOLDIER ELITE CONV SCH, JANDIALA GURU PUNJAB

Dated : 28/09/2020

<b>CLASS</b>	<b>TOTAL NUMBER OF SECTIONS</b>	<b>TOTAL PER CLASS INTAKE</b>	<b>TOTAL NUMBER OF STUDENTS</b>
<b>1</b>	5	139	139
<b>2</b>	4	148	148
<b>3</b>	4	135	135
<b>4</b>	5	151	151
<b>5</b>	4	155	155
<b>6</b>	4	139	139
<b>7</b>	4	144	144
<b>8</b>	5	159	159
<b>9</b>	5	184	184
<b>10</b>	5	164	164
<b>11</b>	5	190	190
<b>12</b>	5	182	182

**ACADEMIC DETAILS**

<b>SUBJECTS OFFERED FOR CLASS 10</b>	<b>SUBJECTS OFFERED FOR CLASS 12</b>
241---MATHEMATICS BASIC 041---MATHEMATICS 184---ENGLISH LANG & LIT. 004---PUNJABI 085---HINDI COURSE-B 086---SCIENCE 087---SOCIAL SCIENCE 165---COMPUTER APPLICATIONS	055---ACCOUNTANCY 044---BIOLOGY 054---BUSINESS STUDIES 043---CHEMISTRY 083---COMPUTER SCIENCE (NEW) 030---ECONOMICS 301---ENGLISH CORE 503---General Studies 502---Health & Physical Education 034---HIND MUSIC.VOCAL 041---MATHEMATICS 048---PHYSICAL EDUCATION 042---PHYSICS 104---PUNJABI 500---Work Experience

**INFRASTRUCTURE DETAILS**

20514--ST SOLDIER ELITE CONV SCH, JANDIALA GURU PUNJAB

Dated : 29/09/2020

<b>TOTAL NUMBER OF SITES OF SCHOOL</b>	1	<b>TOTAL NUMBER OF BUILDING BLOCKS</b>	3
<b>TOTAL AREA OF SCHOOL IN SQUARE METRES</b>	15622	<b>TOTAL NUMBER OF PLAYGROUNDS</b>	4
<b>TOTAL AREA OF PLAYGROUND IN SQUARE METRES</b>	7975	<b>TOTAL NUMBER OF ROOMS</b>	104
<b>TOTAL NUMBER OF SMALL-SIZED ROOMS</b>	21	<b>TOTAL NUMBER OF MEDIUM-SIZED ROOMS</b>	69
<b>TOTAL NUMBER OF LARGE-SIZED ROOMS</b>	11	<b>TOTAL NUMBER OF MALE REST ROOM</b>	2
<b>TOTAL NUMBER OF FEMALE REST ROOM</b>	3	<b>NUMBER OF GIRLS TOILET</b>	20
<b>NUMBER OF BOYS TOILET</b>	18	<b>NUMBER OF TOILETS FOR DIFFERENTLY ABLED PERSONS</b>	2
<b>NUMBER OF WASHROOMS FOR FEMALE STAFF</b>	5	<b>NUMBER OF WASHROOMS FOR MALE STAFF</b>	4
<b>TOTAL NUMBER OF LIBRARIES</b>	1	<b>NUMBER OF LABORATORIES</b>	7

<b>TOTAL NUMBER OF STUDENT CANTEENS</b>	1	<b>TOTAL NUMBER OF STAFF CANTEENS</b>	1
<b>NUMBER OF WATER PURIFIERS/ROs</b>	4	<b>NUMBER OF AUDITORIUMS</b>	1
<b>NUMBER OF LIFTS/ELEVATORS</b>	0	<b>NUMBER OF DIGITAL CLASSROOMS</b>	42
<b>DOES THE SCHOOL HAVE HOSTEL FACILITY</b>	NO	<b>DOES THE SCHOOL HAVE GUARDS EMPLOYED FOR SAFETY</b>	YES
<b>DOES THE SCHOOL HAVE FIRE EXTINGUISHERS</b>	YES	<b>DOES THE SCHOOL HAVE SPRINKLERS</b>	NO
<b>DOES THE SCHOOL HAVE CCTV CAMERAS INSTALLED?</b>	YES	<b>IS THE SCHOOL EXAMINATION CENTER OF CBSE?</b>	NO
<b>TOTAL NUMBER OF COMPUTERS IN ALL COMPUTER LAB</b>	47	<b>DOES THE SCHOOL HAVE WEB SERVERS</b>	YES
<b>DOES THE SCHOOL HAVE A BOUNDARY WALL?</b>	YES	<b>IS YOUR SCHOOL BARRIER FREE/ HAS RAMPS?</b>	NO
<b>DOES THE SCHOOL HAVE CLINIC FACILITY?</b>	YES	<b>DOES THE SCHOOL HAVE A STRONG ROOM?</b>	NO

<b>DOES THE SCHOOL HAVE A GYMNASIUM?</b>	NO	<b>IS YOUR SCHOOL WI-FI ENABLED?</b>	YES
<b>PROVISION OF WEB BASED LEARNING PROGRAMS?</b>	YES	<b>DOES THE SCHOOL HAVE FIRE ALARMS?</b>	YES
<b>DOES THE SCHOOL HAVE SPORTS FACILITY?</b>	YES	<b>DOES THE SCHOOL HAVE INDOOR GAMES FACILITY?</b>	YES
<b>DOES THE SCHOOL HAVE A SWIMMING POOL?</b>	NO	<b>DOES THE SCHOOL HAVE DANCE/MUSIC FACILITY?</b>	YES
<b>TOTAL NUMBER OF BUSES OWNED</b>	10	<b>TOTAL NUMBER OF BUSES HIRED</b>	10
<b>TOTAL NUMBER OF VANS/MATADORS</b>	0	<b>TOTAL NUMBER OF DRIVERS</b>	20
<b>NUMBER OF FEMALE ATTENDANTS FOR BUS DUTY</b>	20	<b>NUMBER OF ACTIVITY ROOMS</b>	3
<b>NAME OF TRANSPORT COORDINATOR</b>	BALBIR SINGH	<b>TRANSPORT COORDINATOR CONTACT</b>	9914328532
<b>BUILDING SAFETY CERTIFICATE</b>	<b>VIEW (PdfHandler.aspx? FileName=G:\cbse\2018\oasis\building\20514.PDF)</b>	<b>TRANSPORT SAFETY CERTIFICATE</b>	<b>VIEW (PdfHandler.aspx? FileName=G:\cbse\2018\oasis\transport\20514.PDF)</b>



<b>ARE THE HEALTH AND HYGIENE, TOILETS ON ALL FLOORS, SEPARATE TOILETS FOR STAFF, RAMPS, SIGNBOARDS, ETC. BEING MAINTAINED PROPERLY?</b>	YES	<b>IS THE SCHOOL INFRASTRUCTURE BEING USED FOR ANY COMMERCIAL ACTIVITY?</b>	NO
--	-----	---	----

**LOCATION DETAILS**

20514--ST SOLDIER ELITE CONV SCH, JANDIALA GURU PUNJAB

Dated : 29/09/2020

<b>NEAREST NATIONALISED BANK</b>	PUNJAB AND SIND BANK	<b>DISTANCE OF BANK FROM SCHOOL IN KM</b>	1
<b>NEAREST BUS STATION</b>	JANDIALA GURU	<b>DISTANCE OF BUS TERMINAL FROM SCHOOL IN KM</b>	1
<b>NEAREST RAILWAY STATION</b>	JANDIALA GURU	<b>DISTANCE OF RAILWAY STATION FROM SCHOOL IN KM</b>	4
<b>NEAREST AIRPORT</b>	GURU RAM DAAS AIRPORT	<b>DISTANCE OF AIRPORT FROM SCHOOL IN KM</b>	30
<b>NEAREST HOSPITAL</b>	MANNAWALA HOSPITAL	<b>DISTANCE OF HOSPITAL FROM SCHOOL IN KM</b>	6
<b>NEAREST POLICE STATION</b>	JANDIALA GURU	<b>DISTANCE OF POLICE STATION FROM SCHOOL IN KM</b>	1
<b>NEAREST METRO STATION</b>		<b>DISTANCE OF METRO FROM SCHOOL IN KM</b>	

**CONTRIBUTION TOWARDS ENVIRONMENT PROTECTION**

20514--ST SOLDIER ELITE CONV SCH, JANDIALA GURU PUNJAB

Dated : 29/09/2020

<b>WHETHER RAIN WATER HARVESTING HAS BEEN DONE IN THE CAMPUS?</b>	YES	<b>WHETHER ROOF WATER HARVESTING IS BEING UNDERTAKEN BY THE SCHOOL?</b>	NO
<b>WHETHER HARVESTED WATER IS RECYCLED FOR GARDENING, ETC?</b>	YES	<b>WHETHER SCHOOL ENSURES MAINTENANCE OF ALL WATER FAUCETS/PIPES ETC TO PREVENT ANY LEAKAGES?</b>	YES
<b>WHETHER SEGREGATION OF WASTE IS DONE AT SOURCE?</b>	YES	<b>WHETHER ORGANIC WASTE IS BEING RECYCLED?</b>	YES
<b>WHETHER WASTE PAPER IS RECYCLED?</b>	YES	<b>WHETHER SCHOOL IS MAKING EFFORTS TO REDUCE USE OF PAPER BY ADOPTING IT SOLUTIONS?</b>	YES
<b>WHETHER THERE IS PROPER DISPOSAL OF SOLID WASTE?</b>	YES	<b>WHETHER THERE IS A SYSTEM FOR DISPOSAL OF ELECTRONIC WASTE?</b>	YES
<b>WHETHER SCHOOL IS USING ENERGY SAVING AND ENERGY EFFICIENT ELECTRICAL EQUIPMENT?</b>	YES	<b>WHETHER PLANTATION/GARDENING HAS BEEN DONE IN AND AROUND CAMPUS?</b>	YES
<b>WHETHER DRIP IRRIGATION IS THE ONLY MEANS OF WATERING THE GARDEN?</b>	NO	<b>WHETHER SCHOOL IS USING SOLAR ENERGY?</b>	YES
<b>WHETHER WASTE WATER FROM RO PLANT FOR DRINKING WATER IS BEING HARVESTED/RECYCLED?</b>	YES	<b>WHETHER SCHOOL IS PROMOTING AWARENESS AMONGST CHILDREN AND PARENTS ON ENVIRONMENTAL CONSERVATION AND CLEANLINESS?</b>	YES
<b>WHETHER CHILDREN ARE BEING TAUGHT HOW TO AUDIT THE USE OF WATER AND WHETHER THEY ARE BEING ENCOURAGED TO TAKE IT UP AT HOME?</b>	YES	<b>WHETHER CHILDREN ARE TAKING UP WATER AUDITING AT SCHOOL?</b>	YES
<b>WHETHER ENVIRONMENTAL LITERACY IS PROMOTED THROUGH INTEGRATION IN ACADEMICS?</b>	YES	<b>WHETHER TREES HAVE BEEN PLANTED BY STUDENTS, IN SCHOOL AT HOME/IN NEIGHBOURHOOD IN THE CURRENT ACADEMIC YEAR?</b>	YES
<b>WHETHER CONSERVATION OF ENVIRONMENT IS PROMOTED?</b>	YES	<b>TOTAL TREES PLANTED? (BY STUDENTS AND TEACHERS)</b>	120
<b>TOTAL AMOUNT OF WATER CONSERVED (IN LITRES)? (BY STUDENTS AND TEACHERS)</b>	14000	<b>TARGET DATE FOR STOPPING USE OF POLYTHENE</b>	07/03/2021



**OTHER VITAL INFORMATION**

20514--ST SOLDIER ELITE CONV SCH, JANDIALA GURU PUNJAB

Dated : 06/10/2020

<b>10th BOARD PASS PERCENTAGE (2014/2015/2016)</b>	100/100/100	<b>12th BOARD PASS PERCENTAGE (2014/2015/2016)</b>	97.14/83.09/97.95
<b>NAME OF WELLNESS/ACTIVITY TEACHER</b>	YES	<b>NAME OF GRIEVANCE/COMPLAINT REDRESSAL OFFICER</b>	Shilpa Sharma
<b>CONTACT NUMBER OF GRIEVANCE/COMPLAINT REDRESSAL OFFICER</b>	9501097250	<b>EMAIL ID OF GRIEVANCE/COMPLAINT REDRESSAL OFFICER</b>	sssharmashilpa11@gmail.com
<b>NAME OF HEAD OF SEXUAL HARASSMENT COMMITTEE</b>	Gurpreet Kaur	<b>CONTACT NUMBER OF HEAD OF SEXUAL HARASSMENT COMMITTEE</b>	9815691700
<b>EMAIL ID OF HEAD OF SEXUAL HARASSMENT COMMITTEE</b>	gunsharan@gmail.com	<b>NAME OF CONTACT PERSON IN CASE OF EMERGENCY</b>	Mangal Singh Kishanpuri
<b>CONTACT NUMBER OF CONTACT PERSON IN CASE OF EMERGENCY</b>	9855488112	<b>EMAIL ID OF CONTACT PERSON IN CASE OF EMERGENCY</b>	stsoldierschool@yahoo.com
<b>TOTAL NUMBER OF DOCTORS IN SCHOOL CLINIC</b>	1	<b>TOTAL NUMBER OF NURSES IN SCHOOL CLINIC</b>	1
<b>TOTAL NUMBER OF BEDS IN SCHOOL CLINIC</b>	2	<b>LEVEL OF INVOLVEMENT OF SCHOOL IN CBSE ACTIVITIES</b>	ACTIVE

<b>DO THE TEACHERS GET PROPER GRADE LIKE PGT/TGT AS PER THE CLASSES THEY ARE ENTITLED TO TEACH?</b>	YES	<b>DO THE TEACHERS AND STAFF GET THEIR SALARY WITHIN FIRST WEEK OF THE MONTH?</b>	YES
<b>DOES THE SCHOOL HAVE EPF FACILITY FOR STAFF</b>	YES	<b>EPF REGISTRATION NUMBER</b>	LDASR0022291000
<b>MODE OF SALARY PAYMENT</b>	bankpayment	<b>NAME OF BANK WITH SALARY ACCOUNT</b>	Punjab & Sind Bank
<b>ARE THE SCHOOL ACCOUNTS AUDITED REGULARLY?</b>	YES	<b>PARENT TEACHERS ASSOCIATION AS PER NORMS</b>	YES
<b>ACADEMIC SESSION</b>	<b>APRIL TO MARCH</b>	<b>VACATION PERIOD</b>	<b>JUNE TO JULY</b>
<b>AUDITED BALANCE SHEET OF SCHOOL</b>	<b>VIEW (PdfHandler.aspx? FileName=G:\cbse\2018\oasis\balance\20514.pdf)</b>	<b>STAFF STATEMENT OF SCHOOL</b>	<b>VIEW (PdfHandler.aspx? FileName=G:\cbse\2018\oasis\staff\20514.pdf)</b>
<b>INCOME AND EXPENDITURE STATEMENT</b>	<b>VIEW (PdfHandler.aspx? FileName=G:\cbse\2018\oasis\income\20514.pdf)</b>	<b>ACADEMIC CALENDAR OF SCHOOL</b>	<b>VIEW (PdfHandler.aspx? FileName=G:\cbse\2018\oasis\academic\20514.pdf)</b>

#### BEST PRACTICES OF SCHOOL

Teachers training ,seminars to update the teachers regularly according to new techniques of Education. Eco Friendly Environment for Education involving students & teachers to save Environment.

**OTHER INFORMATION**

<b>MANDATORY ART EDUCATION FROM CLASS 1 TO 10 -TWO PERIOD A DAY</b>	YES	<b>WHETHER SELECTION OF TEXTBOOKS FOR ALL GRADES ARE AS PER NORMS ((SECTION-2.4.7 (A) OF AFFILIATION BYE-LAWS) (<a href="http://cbseaff.nic.in/cbse_aff/attachment/onlineservices/affiliation-Bye-Laws.pdf">http://cbseaff.nic.in/cbse_aff/attachment/onlineservices/affiliation-Bye-Laws.pdf</a>))?</b>	YES
<b>WHETHER LIST OF PRESCRIBED BOOKS ARE PUBLISHED ON SCHOOL WEBSITE WITH WRITTEN DECLARATION AS PER (SECTION-2.4.7 (B) OF AFFILIATION BYE-LAWS) (<a href="http://cbseaff.nic.in/cbse_aff/attachment/onlineservices/affiliation-Bye-Laws.pdf">http://cbseaff.nic.in/cbse_aff/attachment/onlineservices/affiliation-Bye-Laws.pdf</a>)?</b>	YES	<b>WHETHER INFORMATION AS PER PARA (2.4.9 OF AFFILIATION BYE-LAWS) (<a href="http://cbseaff.nic.in/cbse_aff/attachment/onlineservices/affiliation-Bye-Laws.pdf">http://cbseaff.nic.in/cbse_aff/attachment/onlineservices/affiliation-Bye-Laws.pdf</a>) PUBLISHED ON THE SCHOOL WEBSITE ?</b>	YES
<b>WHETHER ALL GUIDELINES RELATED TO POCSO ACT COMPLIED WITH AS PER (SECTION-14.25 OF AFFILIATION BYE-LAWS) (<a href="http://cbseaff.nic.in/cbse_aff/attachment/onlineservices/affiliation-Bye-Laws.pdf">http://cbseaff.nic.in/cbse_aff/attachment/onlineservices/affiliation-Bye-Laws.pdf</a>)?</b>	YES	<b>WHETHER ANNUAL REPORT CONTAINS INFORMATION AS PER (SECTION-14.5 OF AFFILIATION BYE-LAWS) (<a href="http://cbseaff.nic.in/cbse_aff/attachment/onlineservices/affiliation-Bye-Laws.pdf">http://cbseaff.nic.in/cbse_aff/attachment/onlineservices/affiliation-Bye-Laws.pdf</a>)?</b>	YES
<b>WHETHER DISABLED STUDENTS FACILITATED AS PER (SECTION-14.15 OF AFFILIATION BYE-LAWS) (<a href="http://cbseaff.nic.in/cbse_aff/attachment/onlineservices/affiliation-Bye-Laws.pdf">http://cbseaff.nic.in/cbse_aff/attachment/onlineservices/affiliation-Bye-Laws.pdf</a>)?</b>	YES	<b>WHETHER IN-SERVICE TRAINING ORGANISED AS PER (SECTION-16 OF AFFILIATION BYE-LAWS) (<a href="http://cbseaff.nic.in/cbse_aff/attachment/onlineservices/affiliation-Bye-Laws.pdf">http://cbseaff.nic.in/cbse_aff/attachment/onlineservices/affiliation-Bye-Laws.pdf</a>)?</b>	YES
<b>WHETHER ANNUAL HEALTH CHECK-UP OF STUDENTS DONE AND THEIR RECORDS MAINTAINED ?</b>	YES	<b>NUMBER OF TEACHERS IN SCHOOL WHO DOWNLOADED CBSE SHIKSHA VANI</b>	60

**PEDAGOGICAL PLAN**

<b>ADOPTION OF EXPERIENTIAL LEARNING PEDAGOGY -IN WHICH GRADES</b>	I,II,III,IV,V,VI,VII,VIII,IX,X,XI,XII	<b>WHETHER ANNUAL PEDAGOGICAL PLANS PREPARED, SUBMITTED AND IMPLEMENTATED ?</b>	YES
<b>NUMBER OF TEACHERS TRAINED ON THE ANNUAL THEME OF CBSE - EXPERIMENTAL LEARNING AND INNOVATIVE PEDAGOGY</b>	60		

**FEE STRUCTURE OF SCHOOL**

20514--ST SOLDIER ELITE CONV SCH, JANDIALA GURU PUNJAB

Dated : 06/10/2020

<b>CLASS</b>	<b>ADMISSION FEE (in Rupees)</b>	<b>TUITION FEE (in Rupees)</b>	<b>YEARLY DEVELOPMENT CHARGES (in Rupees)</b>	<b>ANNUAL/MONTHLY OTHER CHARGES FOR OTHER FACILITIES (in Rupees)</b>
<b>PRIMARY</b>	7000	1110	5830	3020
<b>MIDDLE</b>	7000	1150	5980	3370
<b>SECONDARY</b>	7000	1240	7180	3520
<b>SENIOR SECONDARY</b>	7000	1580	8400	5850

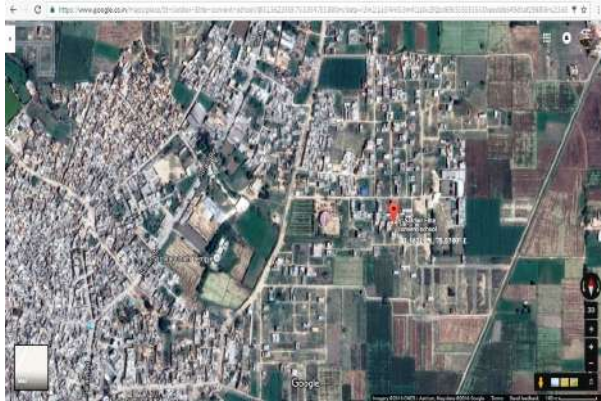

**PHOTO OF SCHOOL**

**SCHOOL PHOTOS**

**Dated :**

**GEO-TAGGED PHOTO**



**PLAYGROUND PHOTO**

**LIBRARY PHOTO**

**SCIENCE LAB PHOTO**

**PHYSICS LAB PHOTO**



**CHEMISTRY LAB PHOTO**

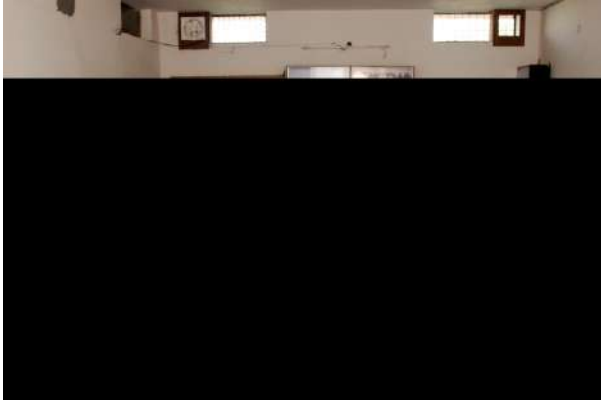

**BIOLOGY LAB PHOTO**

**TOILET PHOTO**

**ADDITIONAL INFORMATION****20514--ST SOLDIER ELITE CONV SCH, JANDIALA GURU PUNJAB****Dated : 06/10/2020**

<b>U-DISE CODE</b>	03020403109
<b>SCHOOL LOCATED IN RURAL OR URBAN AREA</b>	RURAL
<b>HABITATION NAME/MOHALLA</b>	JYOTISAR COLONY
<b>VILLAGE NAME (FOR RURAL)/WARD NUMBER (FOR URBAN)</b>	JANDIALA GURU
<b>VILLAGE PANCHAYAT NAME (FOR RURAL)</b>	JANDIALA GURU
<b>PIN CODE</b>	143115
<b>CLUSTER RESOURCE CENTER NAME</b>	JANDIALA GURU
<b>CD BLOCK MANDAL/TALUKA NAME</b>	AMRITSAR
<b>EDUCATIONAL ZONE/MANDAL/TALUKA NAME</b>	AMRITSAR
<b>ASSEMBLY CONSTITUENCY</b>	JANDIALA GURU
<b>MUNICIPALITY</b>	JANDIALA GURU
<b>IS THIS SCHOOL APPROACHABLE BY ALL WEATHER ROAD</b>	YES
<b>IS THIS A SPECIAL SCHOOL FOR CWSN</b>	NO
<b>IS THIS A SHIFT SCHOOL</b>	NO
<b>IS THIS A RESIDENTIAL SCHOOL</b>	NO
<b>TYPE OF RESIDENTIAL SCHOOL</b>	PRIVATE
<b>IS THIS A RELIGIOUS MINORITY SCHOOL</b>	NO
<b>TYPE OF RELIGIOUS MINORITY SCHOOL</b>	SIKH

<b>NUMBER OF ACADEMIC INSPECTIONS DURING LAST ACADEMIC YEAR</b>	1
<b>NUMBER OF VISITS BY CRC COORDINATOR DURING LAST ACADEMIC YEAR</b>	1
<b>NUMBER OF VISITS BY BLOCK LEVEL OFFICER DURING LAST ACADEMIC YEAR</b>	1

---

**SCHOOL PARTICULARS FOR ELEMENTARY SCHOOLS ONLY**

20514--ST SOLDIER ELITE CONV SCH, JANDIALA GURU PUNJAB

Dated : 06/10/2020

<b>NUMBER OF INSTRUCTIONAL DAYS DURING LAST ACADEMIC YEAR</b>	206
<b>SCHOOL HOURS FOR CHILDREN PER DAY (CURRENT YEAR)</b>	6
<b>SCHOOL HOURS FOR TEACHERS PER DAY (CURRENT YEAR)</b>	6
<b>ARE PUPIL CUMULATIVE RECORDS BEING MAINTAINED?</b>	YES
<b>ARE PUPIL CUMULATIVE RECORDS SHARED WITH PARENTS?</b>	YES
<b>NUMBER OF STUDENTS PROVIDED IN SPECIAL TRAINING (CURRENT YEAR)</b>	397
<b>NUMBER OF STUDENTS ENROLLED IN SPECIAL TRAINING (PREVIOUS YEAR)</b>	270
<b>NUMBER OF STUDENTS COMPLETED SPECIAL TRAINING (PREVIOUS YEAR)</b>	270
<b>HAS SCHOOL MANAGEMENT COMMITTEE (SMC) BEEN CONSTITUTED?</b>	YES
<b>LANGUAGES TAUGHT AT PRIMARY STAGE: MENTION THE NAME OF LANGUAGE OPTIONAL</b>	
<b>IS ANGANWADI CENTRE IN OR ADJACENT TO SCHOOL? OPTIONAL</b>	NO
<b>NUMBER OF MEETINGS HELD BY SMC DURING LAST ACADEMIC YEAR</b>	6
<b>WHETHER SMC PREPARE THE SCHOOL DEVELOPMENT PLAN</b>	YES

**WHETHER SEPARATE BANK ACCOUNT FOR SMC YES IF YES, PROVIDE THESE DETAILS****BANK NAME** PUNJAB AND SIND BANK**ACCOUNT HOLDER'S NAME** PRESIDENT ST SOLDIER DAY SCHOOL SOCIETY**BANK ACCOUNT NUMBER** 001201000053956**IFSC CODE** PSIB0000120**WHEN WAS THE TEXTBOOK RECEIVED FOR CURRENT YEAR?**

FEBRUARY

**WHETHER COMPLETE SET OF FREE TEXT BOOKS FOR TEACHERS LEARNING EQUIPMENT (TLE) RECEIVED?**

YES

**WHETHER TLE RECEIVED FOR EACH GRADE?**

YES

**WHETHER PLAY MATERIAL GAMES AND SPORTS MATERIAL AVAILABLE FOR EACH GRADE?**

YES

**ARE THE MAJORITY OF PUPILS TAUGHT THROUGH THEIR MOTHER TONGUE AT PRIMARY STAGE? OPTIONAL****SCHOOL PARTICULARS FOR SECONDARY AND HIGHER SECONDARY SCHOOLS ONLY**20514--ST SOLDIER ELITE CONV SCH, JANDIALA GURU PUNJAB  
Dated : 06/10/2020**NUMBER OF INSTRUCTIONAL DAYS DURING LAST ACADEMIC YEAR**

206

**SCHOOL HOURS FOR CHILDREN PER DAY (CURRENT YEAR)**

6

**SCHOOL HOURS FOR TEACHERS PER DAY (CURRENT YEAR)**

6

**ARE SCHOOL MANAGEMENT COMMITTEE (SMC) AND SCHOOL MANAGEMENT DEVELOPMENT COMMITTEE (SMDC) SAME?**

YES

**IF NO, UPLOAD DETAILS OF SMDC****VIEW (PdfHandler.aspx?)**

FileName=G:\cbse\2018\oasis\smdc\1630525.pdf)

**PHYSICAL FACILITIES AND EQUIPMENTS**20514--ST SOLDIER ELITE CONV SCH, JANDIALA GURU PUNJAB  
Dated : 29/09/2020

**NUMBER OF CLASSROOMS BY CONDITION**

<b>PUCCA</b>	<b>PARTIALLY PUCCA</b>	<b>KUCHCHA</b>	<b>TENT</b>
101	0	0	0
0	0	0	0
0	0	0	0

**IS LAND AVAILABLE FOR EXPANSION OF SCHOOL ACTIVITIES?** YES

**IS SEPARATE ROOM AVAILABLE FOR PRINCIPAL/HEAD TEACHER?** YES

**IS SEPARATE ROOM AVAILABLE FOR VICE PRINCIPAL/ASSISTANT HEAD TEACHER?** YES

**IS SEPARATE ROOM AVAILABLE FOR CRAFTS/CO CURRICULAR ACTIVITIES?** YES

**IS STAFF QUARTERS AVAILABLE?** NO

**IS HAND WASHING FACILITY AVAILABLE NEAR TOILET/URINALS ?** YES

**IS ELECTRICITY CONNECTION AVAILABLE?** YES

**IS AUDIO/VISUAL/PUBLIC ADDRESS SYSTEM AVAILABLE?** YES

**IS LCD PROJECTOR AVAILABLE?** YES

**NUMBER OF AVAILABLE PRINTERS** 5

**SPEED OF AVAILABLE PRINTERS** 20-40 PPM

**NUMBER OF PHOTOCOPIERS AVAILABLE** 4

**IS LEASE LINE AVAILABLE?** NO

**SPEED OF LEASE LINE (IF AVAILABLE)** 0

**IS SCANNER AVAILABLE?** YES

**IS RAIN WATER HARVESTING IMPLEMENTED?** YES





5	0	0	0	0	0	0	0	0
6	0	0	0	0	0	0	0	0
7	0	0	0	0	0	0	0	0
8	0	0	0	0	0	0	0	0
9	0	0	0	0	0	0	0	0
10	0	0	0	0	0	0	0	0
11	00	0	0	0	0	0	0	0
12	0	0	0	0	0	0	0	0

**MID DAY MEAL INFORMATION** (Only for Government and Aided Schools)

20514--ST SOLDIER ELITE CONV SCH, JANDIALA GURU PUNJAB

Dated : 29/09/2020

STATUS OF KITCHEN SHED (If meal prepared in school)

NOT AVAILABLE

SOURCE OF MDM (If meal not prepared in school)

**SPORTS INFORMATION**

20514--ST SOLDIER ELITE CONV SCH, JANDIALA GURU PUNJAB

Dated : 29/09/2020

AEROBICS    ATHLETICS    BASKETBALL    CHESS    FOOTBALL    HANDBALL    JUDO    KHO KHO    SWIMMING    TABLE TENNIS    VOLLEYBALL  
 ARCHERY    BADMINTON    BOXING    CRICKET    GYMNASTICS    HOCKEY    KABADDI    SHOOTING    TAEKWONDO    TENNIS    YOGA

DOES THE SCHOOL HAVE A MANDATORY SPORTS/GAMES PERIOD FROM CLASS 1 TO 12 EVERY DAY ? YES

**FACILITY INFORMATION**

20514--ST SOLDIER ELITE CONV SCH, JANDIALA GURU PUNJAB

Dated : 29/09/2020

**FACILITY PROVIDED TO PRIMARY STUDENTS**

<b>FACILITY</b>	<b>GENERAL</b>	<b>SC</b>	<b>ST</b>	<b>OBC</b>	<b>MUSLIM MINORITY</b>
FREE TEXT BOOKS	0	5	0	0	0
FREE UNIFORMS	0	5	0	0	0
STATE DEFINED INCENTIVES	0	0	0	0	0

**FACILITY PROVIDED TO UPPER PRIMARY STUDENTS**

<b>FACILITY</b>	<b>GENERAL</b>	<b>SC</b>	<b>ST</b>	<b>OBC</b>	<b>MUSLIM MINORITY</b>
FREE TEXT BOOKS	1	1	0	0	0
FREE UNIFORMS	1	1	0	0	0
STATE DEFINED INCENTIVES	0	0	0	0	0

**FACILITY PROVIDED TO CWSN STUDENTS**

<b>FACILITY</b>	<b>ELEMENTARY</b>	<b>SECONDARY</b>	<b>HIGHER SECONDARY</b>
BRAILL BOOKS/KITS	0	0	0
LOW VISION KIT	0	0	0
BRACES	0	0	0
CRUTCHES	0	0	0
WHEEL CHAIRS	0	0	0
CALIPERS	0	0	0
TRI CYCLES	0	0	0

**Copyright © 2018 CBSE (login.aspx).** All rights reserved.